

NOTE:
 This information is considered historical as it represents channel conditions and configuration at the time of the survey only. User must accept responsibility of ensuring that the accuracy and completeness of provided data is suitable for the needs of the project or study. It is provided "as is" without warranty of any kind, whether express or implied. Under no circumstances will the Government of British Columbia be liable to any person or business entity for any direct, indirect, special, incidental, consequential, or other damages based on any use of this information.

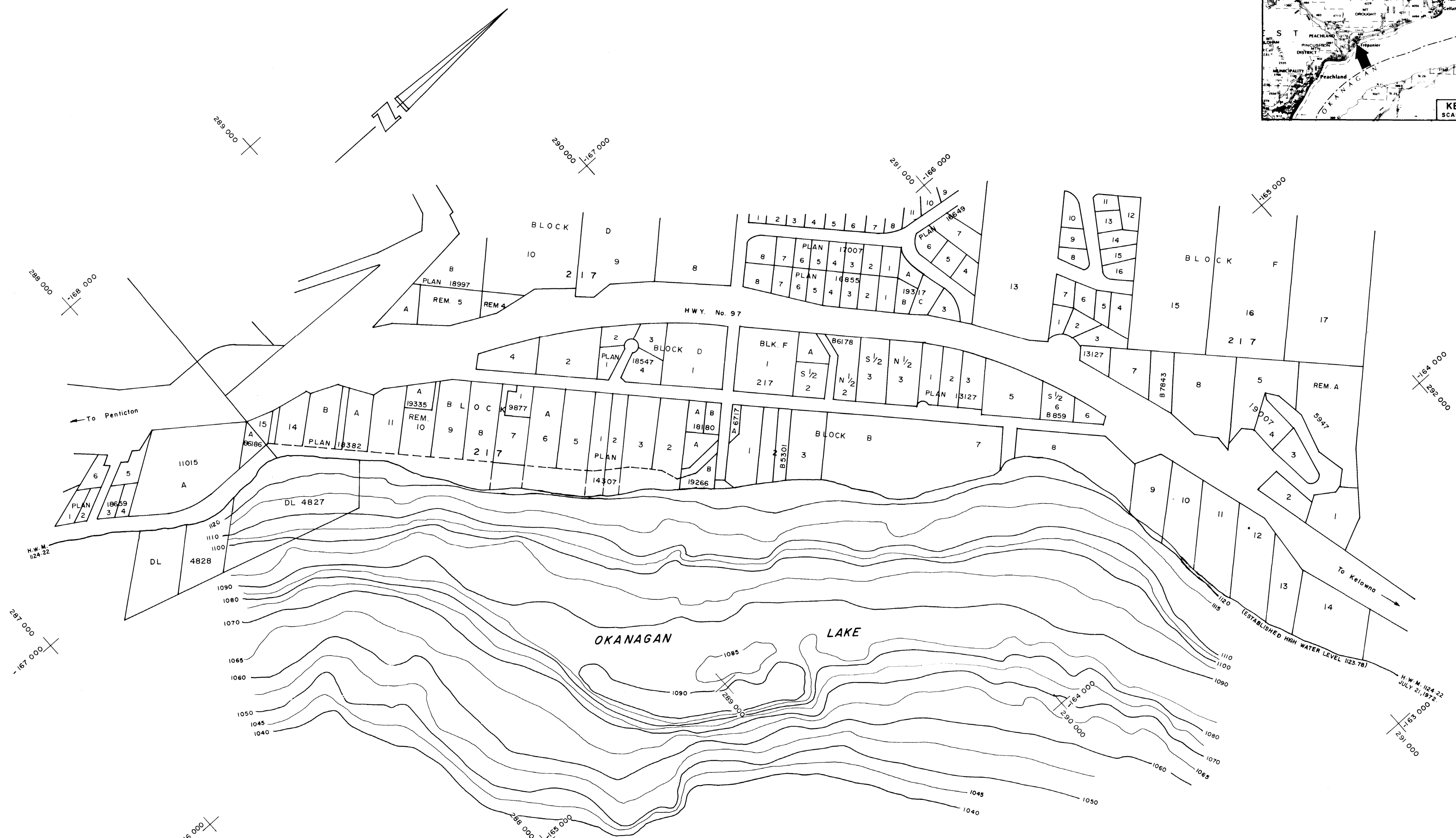
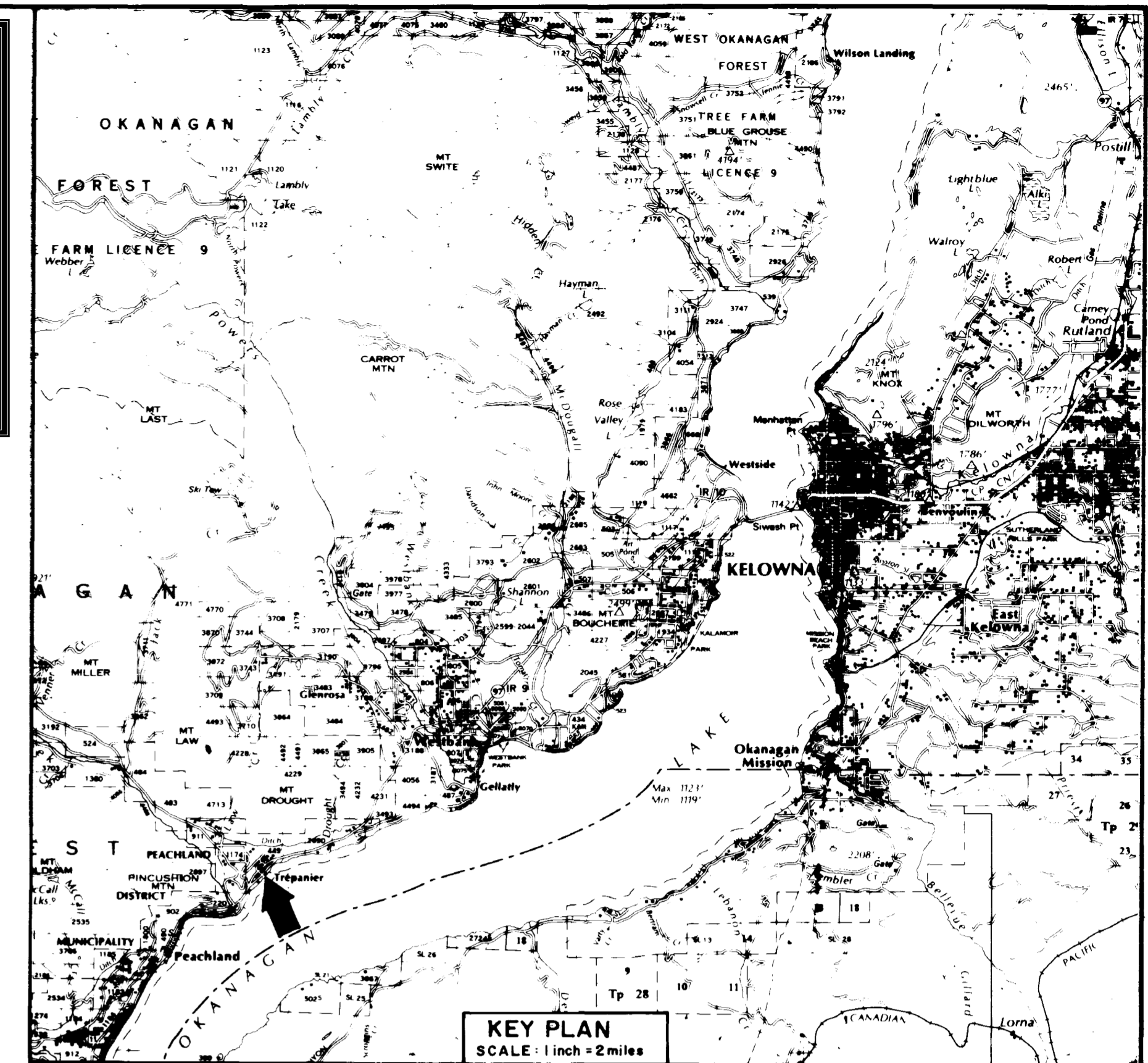

HISTORY		NOTES		LEGEND		STORAGE LICENCES		REFERENCES		REVISIONS		APPROVED		FILE NUMBERS																																											
<p>1 This map has been prepared from field surveys carried out by the Water Investigations Branch of the Water Resources Service, Province of British Columbia.</p> <p>2 SURVEY DATA: (a) Subaqueous contours were obtained by Echo Sounder Raytheon Model DE719 D. (b) The survey was completed in April 1974. (c) Shoreline obtained from Trepanier area mapping of 1972.</p> <p>3 DATUM: (a) Horizontal positions are based on Provincial Topographic Survey Sta. WARNO. (b) Grid origin are referred to 49° and 119°. (c) Elevations are referred to Geodetic Datum and are based on G.S.C. B.M. 1437-J.</p> <p>4 FIELD BOOKS: Data recorded in Field Book No. 1962 A & B.</p>				<p>▲ TRIANGULATION STATION</p> <p>◆ BENCH MARK</p> <p>■ GROUND CONTROL POINT</p> <p>○ AIR PHOTO CENTRE</p> <p>— ROAD</p> <p>- - - TRAIL</p> <p>~ CREEK</p> <p>~ CREEK INTERMITTENT</p> <p>~ CREEK INDEFINITE</p> <p>☁ SWAMP</p> <p>— CONTOURS & ELEVATIONS</p> <p>□ BUILDING</p> <p>— DRAINAGE AREA BOUNDARY</p>		<table border="1"> <thead> <tr> <th>LICENCE</th> <th>PRIORITY DATE</th> <th>AUTHORIZED ACRE - FEET</th> <th>DEVELOPED ACRE - FEET</th> </tr> </thead> <tbody> <tr><td> </td><td> </td><td> </td><td> </td></tr> <tr><td> </td><td> </td><td> </td><td> </td></tr> <tr><td> </td><td> </td><td> </td><td> </td></tr> </tbody> </table>		LICENCE	PRIORITY DATE	AUTHORIZED ACRE - FEET	DEVELOPED ACRE - FEET													<table border="1"> <thead> <tr> <th>DWG. NO.</th> <th>DESCRIPTION</th> <th>DATE</th> </tr> </thead> <tbody> <tr><td> </td><td> </td><td> </td></tr> <tr><td> </td><td> </td><td> </td></tr> <tr><td> </td><td> </td><td> </td></tr> </tbody> </table>		DWG. NO.	DESCRIPTION	DATE										<table border="1"> <thead> <tr> <th>NO.</th> <th>DESCRIPTION</th> <th>DATE</th> </tr> </thead> <tbody> <tr><td> </td><td> </td><td> </td></tr> <tr><td> </td><td> </td><td> </td></tr> <tr><td> </td><td> </td><td> </td></tr> </tbody> </table>		NO.	DESCRIPTION	DATE										<p>SURVEYED: G. Roberts</p> <p>DATE: April 1974</p> <p>DESIGNED: [Signature]</p> <p>DRAWN: [Signature]</p> <p>TRACED: [Signature]</p> <p>CHECKED: [Signature]</p> <p>DATE: JULY 76</p>		<p>BRITISH COLUMBIA DEPARTMENT OF LANDS, FORESTS, AND WATER RESOURCES WATER RESOURCES SERVICE WATER INVESTIGATIONS BRANCH</p> <p>STORAGE INVENTORY PROGRAMME OKANAGAN BASIN - COLUMBIA SYSTEM</p> <p>OKANAGAN LAKE PLAN OF BATHYMETRIC SURVEY TREPANIER AREA MUNICIPALITY OF PEACHLAND</p> <p>APPROVED: [Signature] HEAD, SURVEYS SECTION, PLANNING & SURVEYS DIV.</p> <p>DATE: JULY 76</p>		<p>FILE NUMBERS BRANCH: 0305080-1</p> <p>INVENTORY: 0305080-1</p> <p>SCALE: 1" = 200'</p> <p>SURVEY PROJECT NO. 74-R-3</p> <p>DWG. NO. 4567-76D</p> <p>SHEET 1 of 1</p>	
LICENCE	PRIORITY DATE	AUTHORIZED ACRE - FEET	DEVELOPED ACRE - FEET																																																						
DWG. NO.	DESCRIPTION	DATE																																																							
NO.	DESCRIPTION	DATE																																																							