

NOTE:
 This information is considered historical as it represents channel conditions and configuration at the time of the survey only. User must accept responsibility of ensuring that the accuracy and completeness of provided data is suitable for the needs of the project or study. It is provided "as is" without warranty of any kind, whether express or implied. Under no circumstances will the Government of British Columbia be liable to any person or business entity for any direct, indirect, special, incidental, consequential, or other damages based on any use of this information.

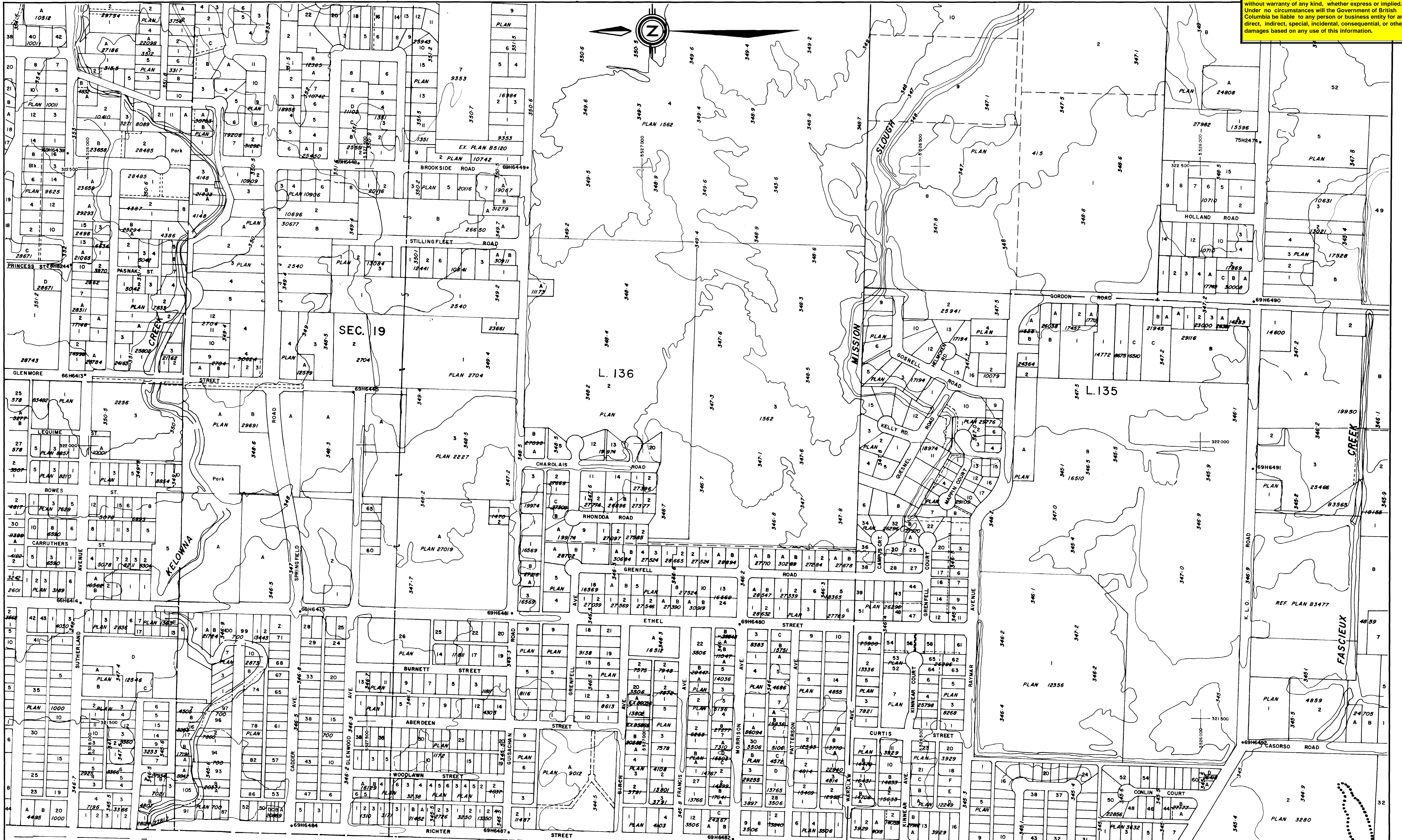

NOTES		LEGEND		KEY MAP		REFERENCES		REVISIONS		APPROVED	
1) This map has been prepared from field surveys carried out by the Surveys Sub-Section, Planning and Surveys Section, Inventory and Engineering Branch, and photogrammetric and cadastral mapping, compiled by the Surveys and Mapping Branch of the Ministry of Environment, Province of British Columbia.	d) Contours between Elevation 342.53 and Elevation 345.0, were drawn from cross-sections obtained by field surveys. The location of cross-section lines was established by photogrammetric identification. Minimum contour interval 0.5 metre.	c) Elevations are based on Canadian Geodetic Datum.	***345.66*** FLOOD PLAIN LIMIT ELEVATION IN METRES	SEE DRAWING NO 4567A-76.		DWG No.	DESCRIPTION	DATE	No.	DESCRIPTION	DATE
2) SURVEY DATA: a) Horizontal control was established by traverse using Hewlett-Packard Distance Meter, Model 3800B. b) Subsequent contours were drawn from depths established by Raytheon Depth Recorder, Model DE-719B. c) Position control for bathymetry was maintained by simultaneous fixes from theodolites which were set over coordinated shore stations.	e) The survey was carried out during the period August-September, 1979.	4) FIELD BOOKS: Survey data are recorded in Field Book No's. 2212 P1, 2212 L1 to 2213 L3, inclusive, and 2212 I1.	--- 342.53 --- NORMAL HIGH WATER OPERATING LEVEL	SCALE 1:2500		CHECKED					
	3) DATUM: a) The horizontal control is based on Integrated Survey Monument No's. 75H2855, 75H2466, 6437, 6483, 6419, and 6470, Kelowna, established by the Field Operations Division, Surveys and Mapping Branch. b) Coordinates are Universal Transverse Mercator, Zone 11, Central Meridian 117°.	5) MAPPING: The area above contour 345.0 was mapped under Project No's. 72-5T and 79-101T-0 at a scale of 1:5000, using second order photogrammetric equipment.				DATE	SEPT. 1979				
		6) REFERENCE MONUMENTS: Northings Eastings Elevations WRS Mon. 1688 5 527 523.107 318 404.922 343.451 WRS Mon. 1687 5 525 975.702 318 019.806 343.544 Mon. 1688 - Mon. 1687 - S 139° 58' 53" W - 1594.61				DATE	FEB. 1981				
<p>Province of British Columbia Ministry of Environment WATER MANAGEMENT BRANCH</p> <p>STORAGE INVENTORY PROGRAMME OKANAGAN BASIN - COLUMBIA SYSTEM</p> <p>OKANAGAN LAKE BATHYMETRIC PLAN OF LAKE SHELF KELOWNA AREA</p> <p>APPROVED: <i>Robert J. Davis</i> HEAD, SURVEYS SUBSECTION DATE: FEB. 1981</p>										<p>FILE No. 0305080-1</p> <p>INVENTORY PROJECT No. 74-F</p> <p>NTS Map No. 82 E</p> <p>SCALE 1:2500</p> <p>DRAWING No. 4567-76-P</p> <p>SHEET 28 OF 103</p>	