

@ Summit

APPLICATION FOR ECOLOGICAL RESERVE

1. Legal description of the area (or general "Metes and bounds" description)

2. Geographical location (relate to nearest settlement, mountain, river, etc.)
 Blueberry Bog, ca. 4 mi. E. of Summit Lake

3. Indicate the biogeoclimatic zone of which the reserve is representative.
 SBS

4. Approximate total acreage.
 29 acres

5. Purpose of the reserve.
 Conservation of a small but interesting Sphagnum bog within an otherwise logged-over area.
 - (a) Primary (state acreage)
 29 acres
 - (b) Others if any (state acreage)
 --
 - (c) Buffer areas (state acreage)
 --

6. Attach a map and indicate: (a) the perimeters and acreage of the areas detailed in 5 above, and
 (b) indicate the species and total timber volumes in these areas.

Picea mariana, Pinus contorta (occasional) - all in poor growth and unmerchantable.



 Signature J. Pojar, C. Parsons, V.J. Krajina
I.B.P. Surveyor

TABLEAU D'ASSEMBLAGE DU SYSTÈME NATIONAL DE RÉFÉRENCE CARTOGRAPHIQUE

123°00'	122°15'		
54°45'	93 J/10 W	93 J/10 E	93 J/9 W
	93 J/7 W	93 J/7 E	93 J/8 W
54°00'	93 J/2 W	93 J/2 E	93 J/1 W
123°00'	122°15'		

INDEX TO ADJOINING MAPS OF THE NATIONAL TOPOGRAPHIC SYSTEM
SCALE 1:50,000

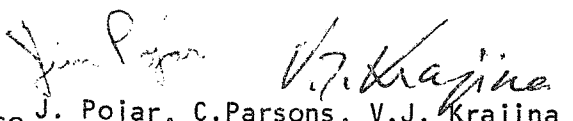
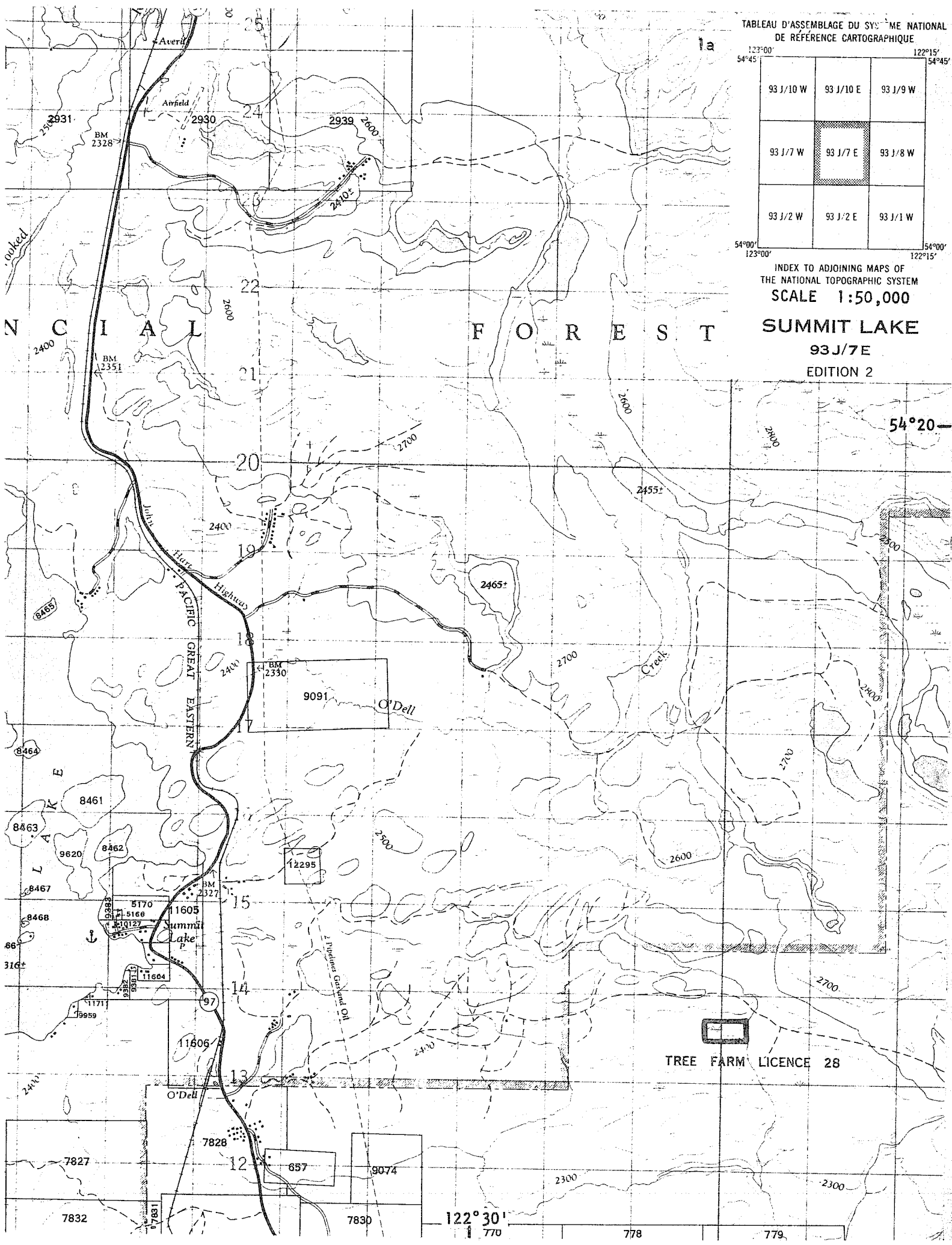
SUMMIT LAKE
93 J/7 E
EDITION 2



54°20'

TREE FARM LICENCE 28

122°30'

778 779

3. Location of IBP Area*

1. Latitude 54 ° 16.3-16.4' N Longitude 122 ° 32.1-32.6' W
2. Country Canada.....
- State or Province .. British Columbia County .. Prince George
- (State or Province County)

4. Administration

- National 1. Official category .. Crown Land (Tree Farm License 28)
2. Address of administration B.C. Department of Lands, Forests, and Water Resources Parliament Bldgs. Victoria, B.C., Canada

International Class

3. Included in U.N. List	Rejected from U.N. List	Area with formal conservation status	No formal cons. status
(A)	(B)	(C)	(D) <input checked="" type="checkbox"/>

5. Characteristics of IBP Area*

1. Surface area (state units of measurement) 29 acres
2. Altitude (state units of measurement) Maximum ca. 2275 ft. (690 m)
- Minimum ca. 2275 ft. (690 m)

6. Climate

Nearest climatological station :

1. Name Prince George - Airport
2. Climatological station on IBP Area*? Yes No
3. If (2) not, distance from edge of IBP Area* (state units) 28 mi.
4. Direction from IBP Area* S.S.W.
5. Additional data sheet attached? Yes No

PRINCE GEORGE AIRPORT 53°53'N, 122°40'W, 2218' ASL. Record: 25-29 years.

Months above 50°F: 3, below 32°F: 5, A.M.T.P.: 24.43", A.M.S.F.: 91.9", snow % A.M.T.P.: 37.51, days with frost, yearly: 203.

E.MAX.T.	55	55	64	74	86	93	94	92	84	77	61	53
M.D.MAX.T.	19.0	30.5	38.3	49.6	61.6	67.8	71.8	69.4	61.5	49.3	33.8	25.4
M.D.T.	10.7	20.8	28.3	39.1	49.0	55.4	58.9	56.7	49.7	40.4	26.9	18.3
M.D.MIN.T.	2.4	11.2	18.2	28.6	36.3	43.0	45.9	44.0	37.8	31.5	20.0	11.1
E.MIN.T.	-58	-49	-36	-14	17	27	29	25	10	-14	-43	-50

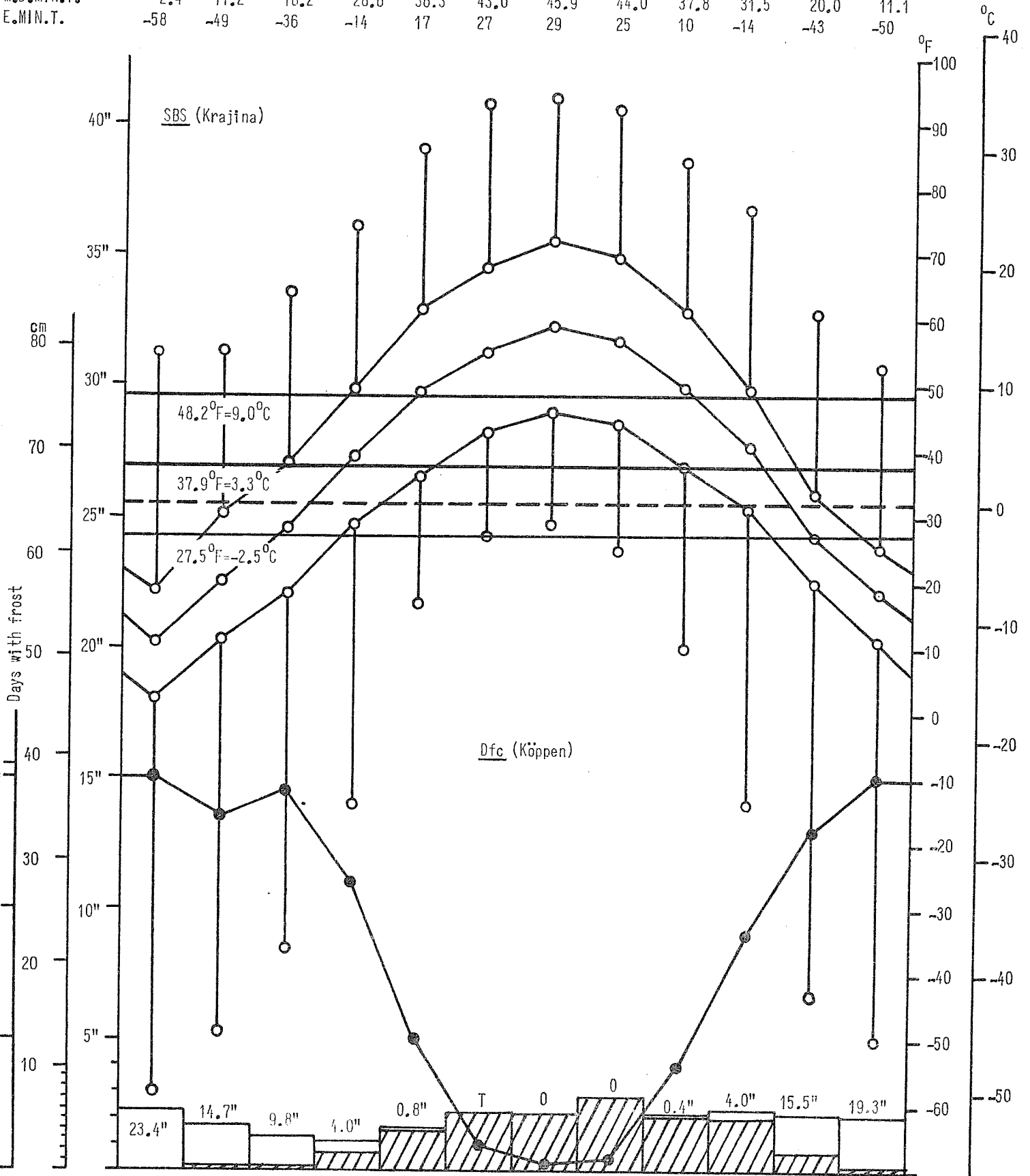

Days with frost	30	27	29	22	10	2	*	1	8	18	26	30
M.M.T.P.	2.33	1.69	1.24	1.16	1.66	2.29	2.28	2.89	2.20	2.40	2.16	2.13
MONTH	JAN	FEB	MAR	APR	MAY	JUN	JUL	AUG	SEP	OCT	NOV	DEC

7.

Vegetation and Soil

1

Vegetation

Community Reference Number	Vegetation Code					Plant communities (give usual name using full Latin names of a species where applicable)	Area (state units)
	Primary Structural Group	Class	Group	Formation	Sub-Formation		
1	1	D	1	4	a	<i>Sphagnum</i> spp. - <i>Tomenthypnum nitens</i> - <i>Betula pumila</i> - <i>Picea mariana</i> bog forest	
2	1	G	2	1		<i>Sphagnum</i> spp. - <i>Tomenthypnum nitens</i> - <i>Vaccinium oxycoccus</i> - <i>Betula pumila</i> low moor	
3	1	O	1	1		<i>Sphagnum</i> spp. - <i>Carex pauciflora</i> - <i>Tofieldia glutinosa</i> high moor	
4							
5							
6							
7							
8							
9							
10							
11							
12							
13							
14							
15							
16							
17							
18							
19							
20							

Please give information about further communities on a separate sheet

Partial species list:

(1) bog forest

- trees: *Picea mariana*
occasional *Abies lasiocarpa*
- shrubs: *Ledum groenlandicum*
Sorbus scopulina
Vaccinium caespitosum
V. membranaceum
V. myrtilloides
V. ovalifolium
- herbs: *Aralia nudicaulis*
Carex trisperma
Coptis trifolia
Cornus canadensis
Dryopteris austriaca
Equisetum arvense
E. pratense
E. sylvaticum
Gymnocarpium dryopteris
Gaultheria hispidula
Geocaulon lividum
Listera cordata
Lysichitum americanum
Rubus pedatus
R. pubescens
Streptopus amplexifolius
S. roseus
S. streptoides
- moss layer: *Pleurozium schreberi*
Ptilium crista-castrensis
Sphagnum spp.
Peltigera aphthosa
P. malacea
- epiphytes: *Alectoria jubata* agg.
A. sarmentosa

(2) low moor

- trees: *Picea mariana*
- shrubs: *Alnus tenuifolia*
Betula glandulosa
B. pumila
Ledum groenlandicum
Lonicera involucrata
Salix pedicellaris
S. pyrifolia
Spiraea douglasii var. *menziesii*
- herbs: *Athyrium filix-femina*
Calamagrostis canadensis
Carex aquatilis
C. disperma
Cornus canadensis

(2) (cont'd):

herbs: *Equisetum arvense*
E. fluviatile
E. pratense
Eriophorum angustifolium
Habenaria hyperborea
Lysichitum americanum
Potentilla palustris
Pyrola asarifolia
P. secunda
Tiarella unifoliata
Trientalis arctica
Veratrum viride

moss layer: *Aulacomnium palustre*
Tomenthypnum nitens
Sphagnum spp.

(3) high moor

trees: stunted *Picea mariana* and occasional *Pinus contorta*

shrubs: *Andromeda polifolia* (dominant)
Kalmia polifolia
Ledum groenlandicum

herbs: *Carex pauciflora*
Drosera rotundifolia
Eriophorum angustifolium
Tofieldia glutinosa
Spiranthes romanzoffiana
Vaccinium oxycoccus (chamaephyte)

moss layer: *Sphagnum* spp.
Icmadophila ericetorum
Cladonia deformis
C. gracilis

7.
(cont.)

2

Soil

Community Reference Number	Soil type	Other notes
1	A 0	Bog (forest) - closer to low moor
2	A 0	(Bog) Fen - low moor
3	A 0	Peat Bog - high moor
4		
5		
6		
7		
8		
9		
10		
11		
12		
13		
14		
15		
16		
17		
18		
19		
20		

9. Landscape

1. General Landscape (give brief description)
 Small Sphagnum bog in a depression set in undulating terrain.

2. Relief Type

	Flat	Undulating (0)-200 m.	Hilly 200-1000 m.	Mountainous > 1000 m.	%
Sharply dissected					
Gently dissected			100		100
Incised					
Skeletonised					
%			100		100%

3. Special landscape features (list)
 Sphagnum bog.

10. Coastline of IBP Area* NONE

1. Protected bays and/or inlets Many Few None

2. Substratum. % of coast

Rock	Boulder Beach	Shingle Beach	Sand Beach	Shell Beach	Mud	Coral	Ice
<input type="checkbox"/>	<input type="checkbox"/>	<input type="checkbox"/>	<input type="checkbox"/>	<input type="checkbox"/>	<input type="checkbox"/>	<input type="checkbox"/>	<input type="checkbox"/>

3. Physiography. % of coast

Cliffed	Sloping	Flat
<input type="checkbox"/>	<input type="checkbox"/>	<input type="checkbox"/>

4. Special Coastal Features (list)

5. Tide. Maximum range (state units of measurement)

6. Total length of coastline :

Less than 1 km. 1-10 km. Above 10 km.

11. Freshwater within IBP Area*

1.

	Permanent	Intermittent
General	X	X
Standing	X	
Running		X

2. Standing Water

	Permanent	Intermittent	Unproductive	Productive
Swamps	X		X	
Ponds				
Lakes				

3. Running Water

	Permanent	Intermittent
Springs, cold		
Springs, hot		
Streams		X
Rivers		

4. Special freshwater features

.....

12. Salt and Brackish Water within IBP Area* NONE

Salt Lakes	<input type="checkbox"/>	Lagoon	<input type="checkbox"/>	<input type="checkbox"/>
Estuaries	<input type="checkbox"/>	Salt pools	<input type="checkbox"/>	<input type="checkbox"/>

13. Adjacent Water Bodies (not within IBP Area*)

1. Fresh Lake River Stream
 especially Summit Lake

2. Salt and Brackish NONE

Estuary	Salt lake	Salt pool	Lagoon	Ocean		

14. Outstanding Floral and Faunal Features

1. None

2. Fauna

	Species diversity	Abundance of individuals	Superabundance of individuals	Rare species	Threatened/Relict species	Spp. of biogeographical interest	Exceptional Associations	Breeding or Nesting Populations	Migrating Populations	Wintering Populations		
Mammalia		X								X		
Aves		X							X			
Reptilia												
Amphibia												
Pisces												
Insecta		X										

3. Names of main threatened, endemic, relict and rare species

.....

.....

.....

.....

.....

.....

.....

.....

4. Flora

	Species diversity	Abundance of particular species	Rare species	Threatened/relict species	Spp. of biogeographical interest	Exceptional associations	Outstanding specimens				
Angiospermae :											
trees											
shrubs		X									
herbs		X	X			X					
grass		X									
Gymnospermae		X									
Pteridophyta											
Bryophyta	X	X				X					
Lichens and Algae		X									

5. Names of main threatened, endemic, relict and rare species

Occurrence of Salix pyrifolia extends S.W. limit of its

 range. Carex trisperma is a very rare sedge in B.C.

15. Exceptional Interest of IBP Area*

A variety of bog communities, separated by remarkably sharp

 boundaries, within a small area.

16. Significant Human Impact

1. General : None in entire IBP Area* X
 None in part of IBP Area*
 Impact on entire IBP Area*

2. Particular

	Past impact	Present impact	Trend			
			Increasing	Decreasing	No change	No information
Cultivation					X	
Drainage					X	
Other soil disturbance					X	
Grazing					X	
Selective flora disturbance					X	
Logging			X			
Plantation					X	
Hunting			X			
Removal of predators					?	
Pesticides					X	
Introductions — plants			?		X	
Introductions — animals					X	
Fire					X	
Permanent habitation					X	
Recreation and tourism					X	
Research			X			

in surrounding area

3. Additional details on each type of impact attached?

Yes No X

17. Conservation Status (required)

	Protection			Utilisation			Conservation Management			Permitted Research		
	none	partial	total	none	controlled	uncontrolled	none	to alter status	to maintain status	experimental	observational	prohibited
Flora			X	X								
Fauna			X	X								
Non-living			X	X								

18. References

1. List major biological/geographical references for the IBP Area.

Sheet attached? Yes No

2. List main maps available for the IBP Area. 93 J/7 East Half

List attached? Yes No

3. Aerial photographs for the IBP Area available?

For whole area For part of area None

19. Other Relevant Information

Typical upland bog which should be kept as an ecological reserve. Tree farm licence will not be financially affected.

Jim Pojar V.J. Krajina

Signed J. Pojar, C. Parsons, V.J. Krajina
(Surveyor)